



Standard Specifications

BU015N-C

1st ed. 02-Sep-19

2nd ed. 05-Mar-21

Kawasaki Heavy Industries, Ltd.
Robot Business Division

Specification number : 90151-0311DEB

Robot specifications

1. Model	BU015N-C																						
2. Type	Articulated robot																						
3. Degree of freedom	6 axes																						
4. Max. payload	15 kg																						
5. Max. reach	1,550 mm																						
6. Position repeatability	±0.04 mm (wrist flange surface) conforms to ISO 9283																						
7. Axis specification	<table border="1"> <thead> <tr> <th>Operating axis</th> <th>Motion range</th> <th>Max. speed</th> </tr> </thead> <tbody> <tr> <td>Arm rotation (JT1)</td> <td>±180°</td> <td>250° /s</td> </tr> <tr> <td>Arm out-in (JT2)</td> <td>+ 140° - - 105°</td> <td>250° /s</td> </tr> <tr> <td>Arm up-down (JT3)</td> <td>+ 155° - - 120°</td> <td>215° /s</td> </tr> <tr> <td>Wrist swivel (JT4)</td> <td>±210°</td> <td>280° /s</td> </tr> <tr> <td>Wrist bend (JT5)</td> <td>±120°</td> <td>280° /s</td> </tr> <tr> <td>Wrist twist (JT6)</td> <td>±360°</td> <td>360° /s</td> </tr> </tbody> </table>		Operating axis	Motion range	Max. speed	Arm rotation (JT1)	±180°	250° /s	Arm out-in (JT2)	+ 140° - - 105°	250° /s	Arm up-down (JT3)	+ 155° - - 120°	215° /s	Wrist swivel (JT4)	±210°	280° /s	Wrist bend (JT5)	±120°	280° /s	Wrist twist (JT6)	±360°	360° /s
Operating axis	Motion range	Max. speed																					
Arm rotation (JT1)	±180°	250° /s																					
Arm out-in (JT2)	+ 140° - - 105°	250° /s																					
Arm up-down (JT3)	+ 155° - - 120°	215° /s																					
Wrist swivel (JT4)	±210°	280° /s																					
Wrist bend (JT5)	±120°	280° /s																					
Wrist twist (JT6)	±360°	360° /s																					
8. Load capacity of wrist	<table border="1"> <thead> <tr> <th></th> <th>Max. torque</th> <th>Moment of inertia*</th> </tr> </thead> <tbody> <tr> <td>JT4</td> <td>27.0 N·m</td> <td>0.70 kg·m²</td> </tr> <tr> <td>JT5</td> <td>27.0 N·m</td> <td>0.70 kg·m²</td> </tr> <tr> <td>JT6</td> <td>22.0 N·m</td> <td>0.25 kg·m²</td> </tr> </tbody> </table> <p>Note * Each value in this table shows allowable moment of inertia of JT4/JT5/JT6 when max. allowed torque is applied to each axis. If more detailed data is required for your application, please contact Kawasaki.</p>			Max. torque	Moment of inertia*	JT4	27.0 N·m	0.70 kg·m ²	JT5	27.0 N·m	0.70 kg·m ²	JT6	22.0 N·m	0.25 kg·m ²									
	Max. torque	Moment of inertia*																					
JT4	27.0 N·m	0.70 kg·m ²																					
JT5	27.0 N·m	0.70 kg·m ²																					
JT6	22.0 N·m	0.25 kg·m ²																					
9. Mass	160 kg (without options)																						
10. Mounting	Floor mounting																						
11. Installation Environment	Ambient Temperature: 0 - 45 °C																						
	Relative Humidity: 35 - 85 % (with no dew condensation)																						
12. Color	Munsell 10GY9/1 equivalent																						
13. Options	Mechanical stopper	Adjustable stopper JT1																					
	Installation stand	300 mm / 600 mm height																					
	Base plate	750 mm × 750 mm																					
	Traverse unit																						
	Color																						

Consult Kawasaki about maintenance parts and spare parts.

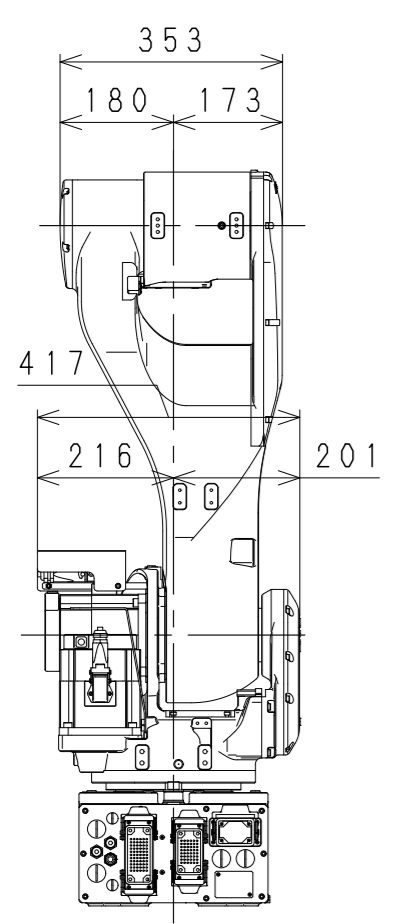
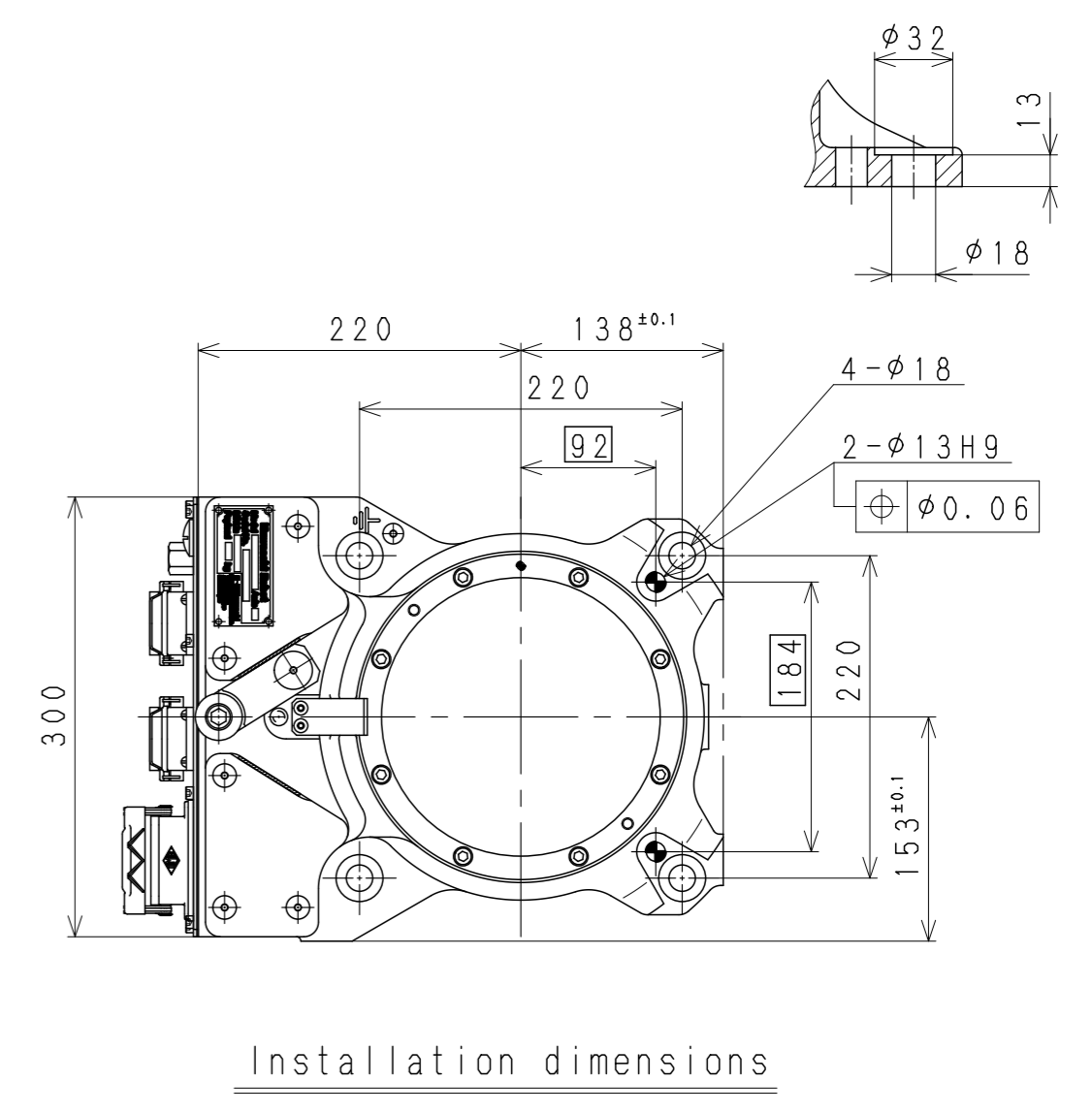
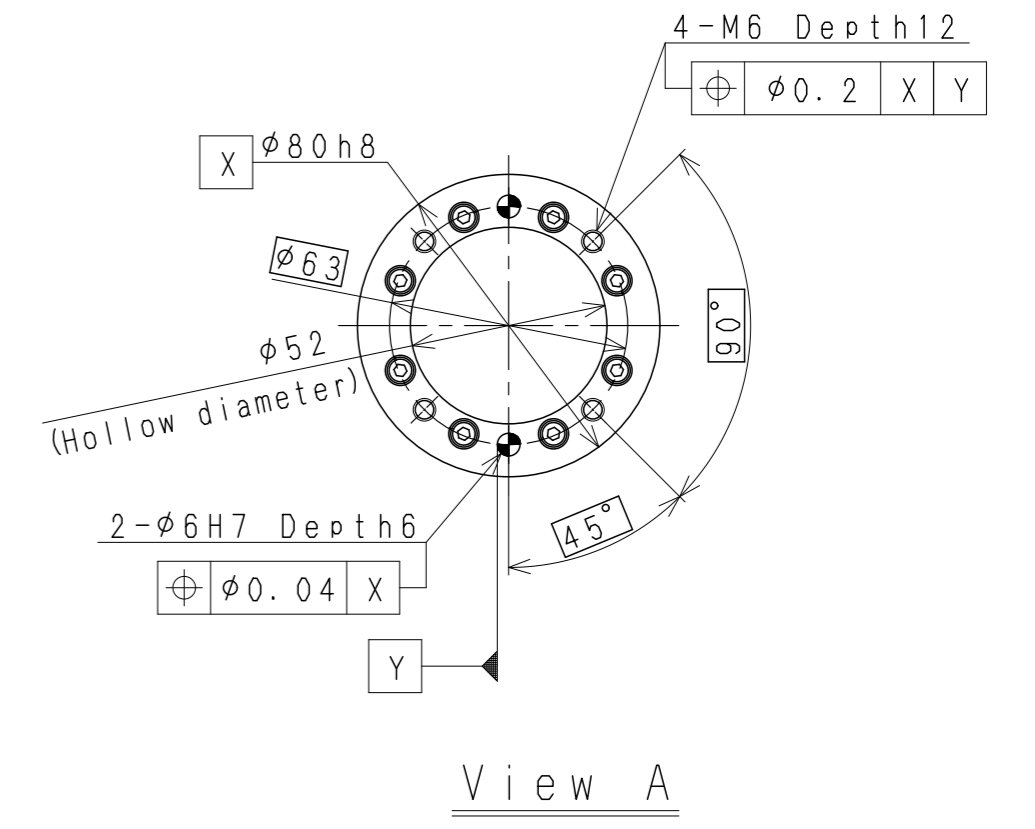
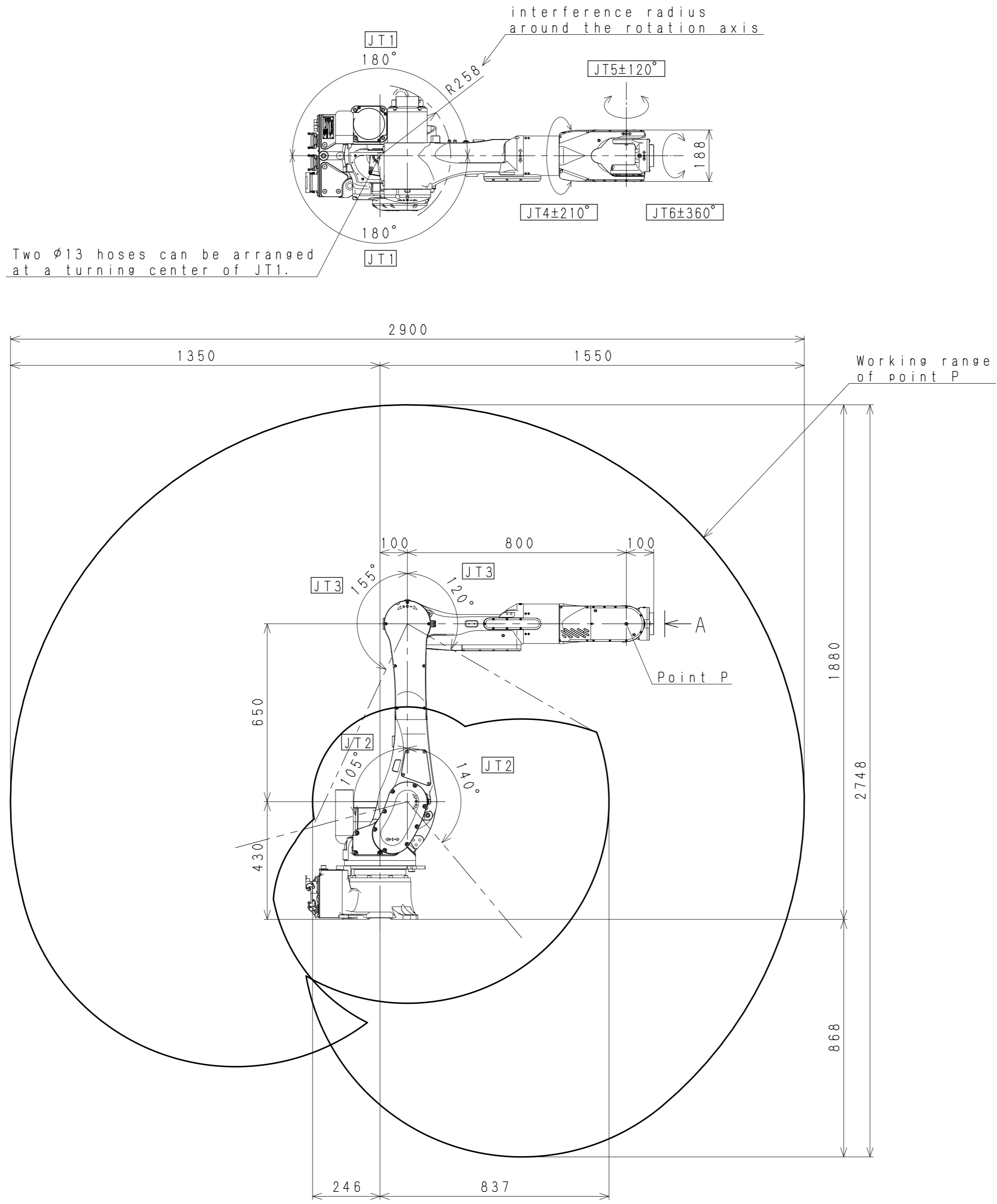

BU015N-C
WORKING RANGE

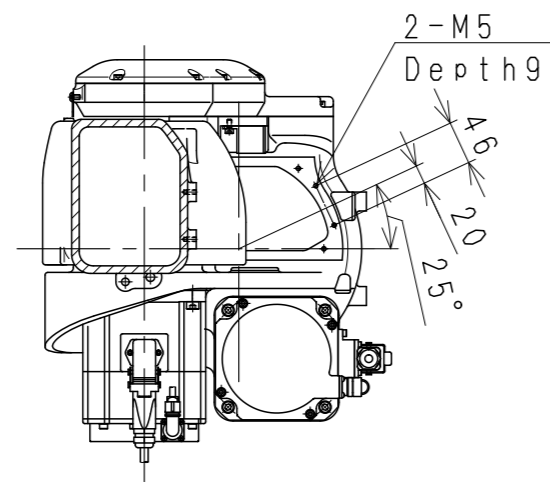

Section A-A

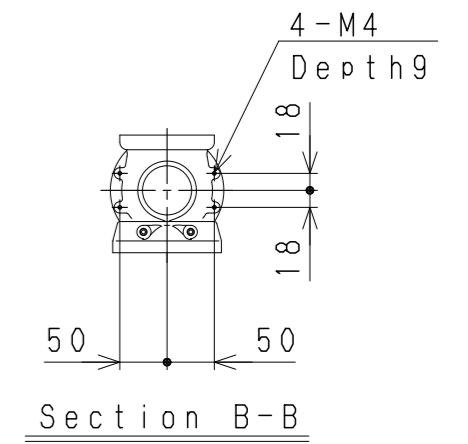
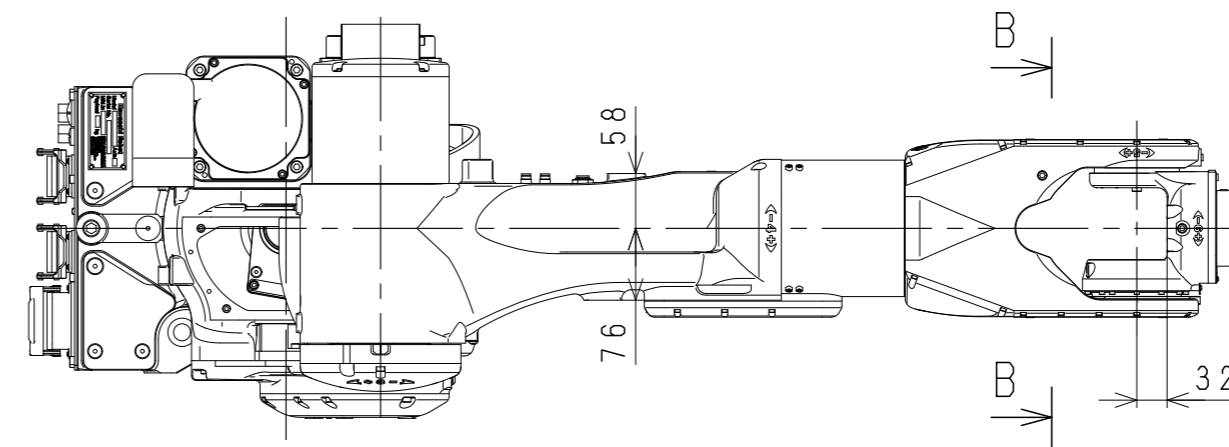

Section B-B

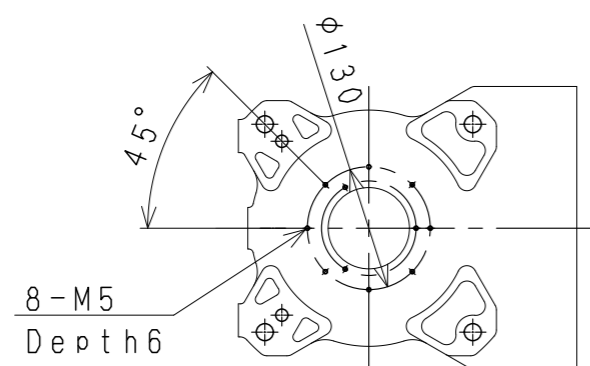
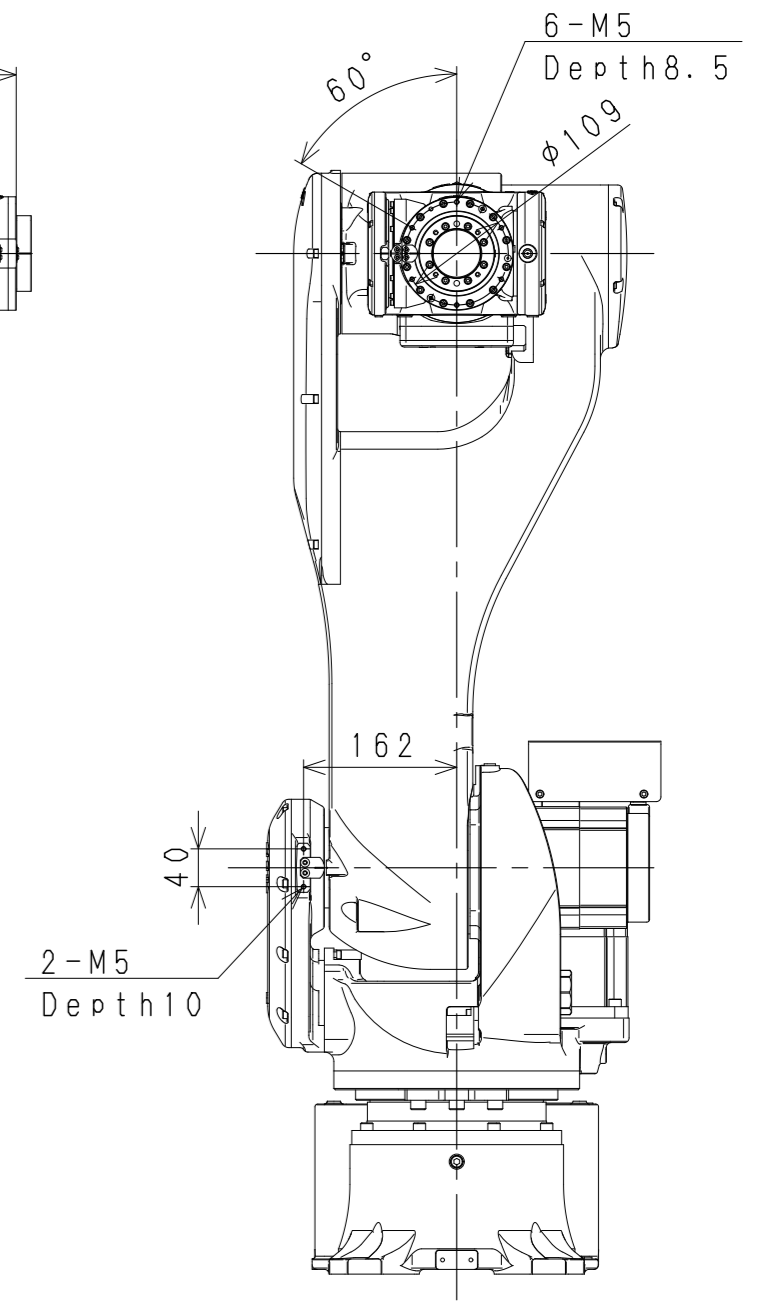
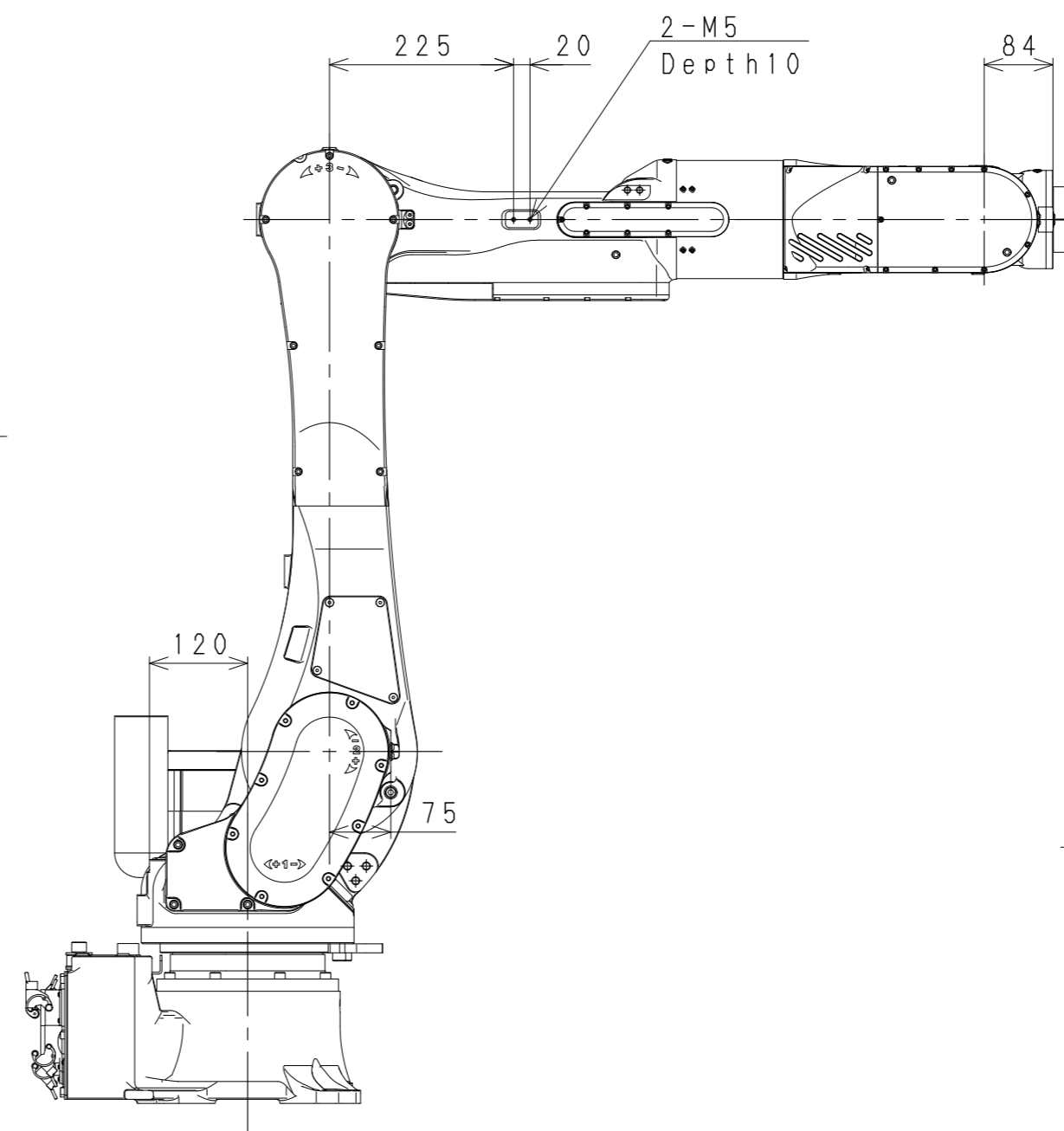
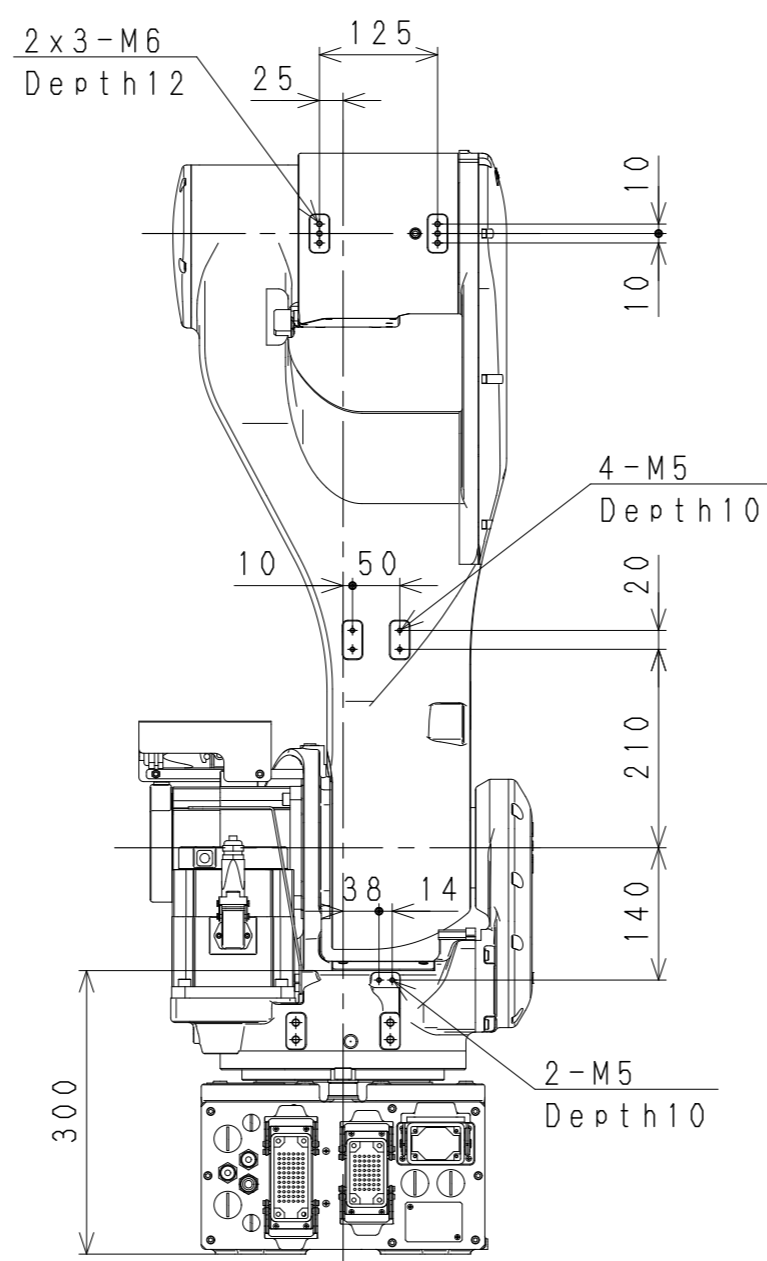
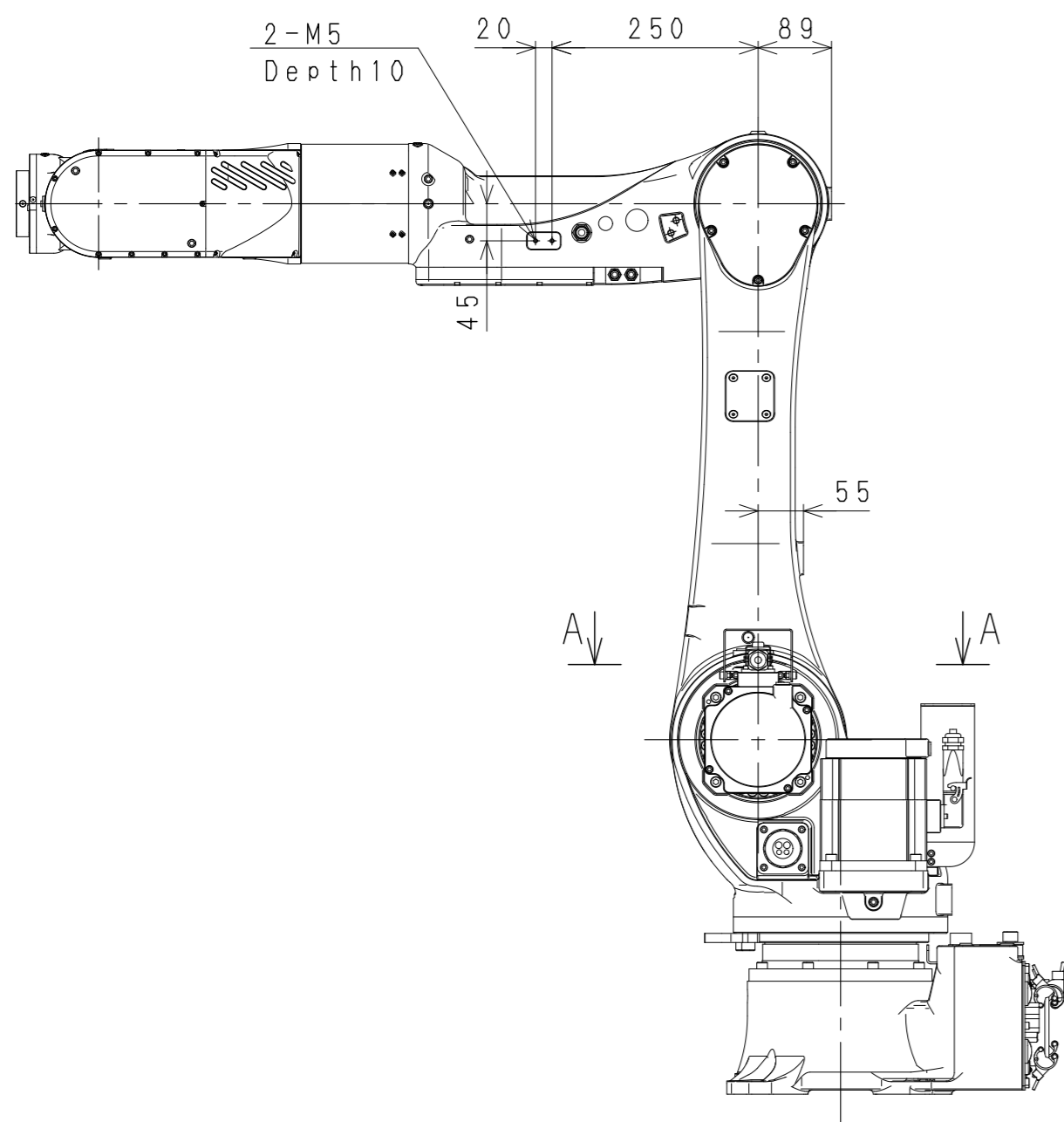

BU015N-C
Service Tapped Hole Positions