



Standard Specifications

BXP110S-A

1st ed. 16-Feb-21

2nd ed. 22-Feb-21

Kawasaki Heavy Industries, Ltd.
Robot Business Division

Specification number : 90151-0355DEB

Materials and specifications are subject to change without notice.

Robot specifications

1. Model	BXP110S-A	
2. Type	Articulated robot	
3. Degree of freedom	6 axes (Option 7 axes)	
4. Max. payload	110 kg	
5. Max. reach	1,634 mm	
6. Position repeatability	±0.06 mm (wrist flange surface) conforms to ISO 9283	
7. Axis specification	Operating axis	Motion range
	Arm rotation (JT1)	±160°
	Arm out-in (JT2)	+ 120° - - 65°
	Arm up-down (JT3)	+ 90° - - 81°
	Wrist swivel (JT4)	±210°
	Wrist bend (JT5)	±125°
	Wrist twist (JT6)	±210°
8. Load capacity of wrist		Max. torque
	JT4	855 N·m
	JT5	855 N·m
	JT6	445 N·m
		Moment of inertia*
		90 kg·m ²
		90 kg·m ²
		50 kg·m ²
	Note* Each value in this table shows allowable moment of inertia of JT4/JT5/JT6 when max. allowed torque is applied to each axis. If more detailed data is required for your application, please contact Kawasaki.	
9. Mass	700 kg (without options)	
10. Mounting	Floor mounting	
11. Installation Environment	Ambient Temperature:	0 - 45 °C
	Relative Humidity:	35 - 85 % (with no dew condensation)
12. Color	Munsell 10GY9/1 equivalent	
13. Degree of protection	Wrist: IP67 equivalent, Arm: IP54 equivalent	
14. Dressing	Cable length between flange and tool is 1.5m. Consult Kawasaki when non-standard dressing will be applied.	
15. Options	Mechanical stopper	Adjustable stoppers JT1/JT2/JT3
	Adapter bracket	between flange and tool

Consult Kawasaki about maintenance parts and spare parts.

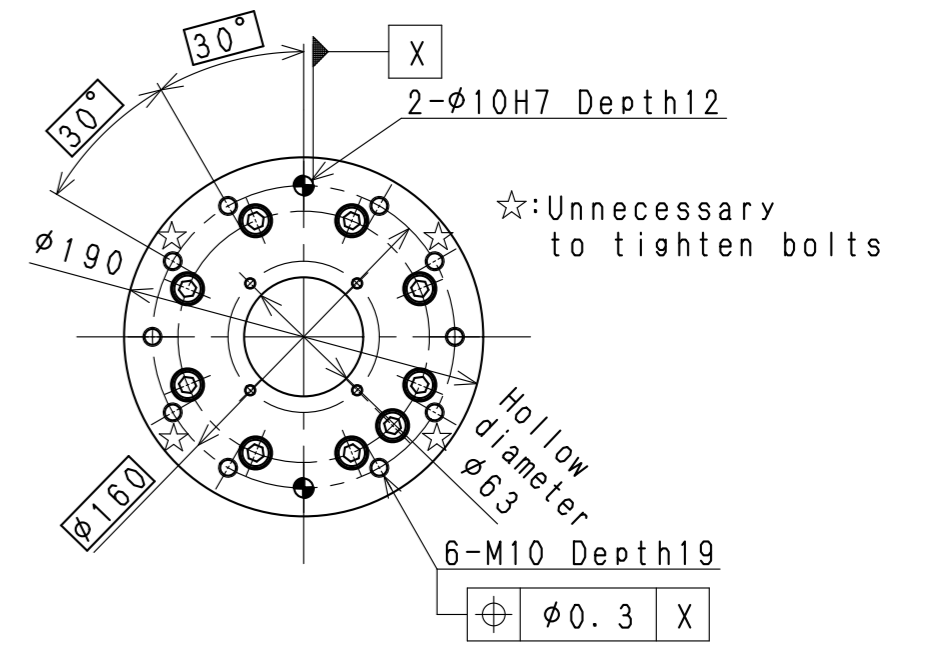
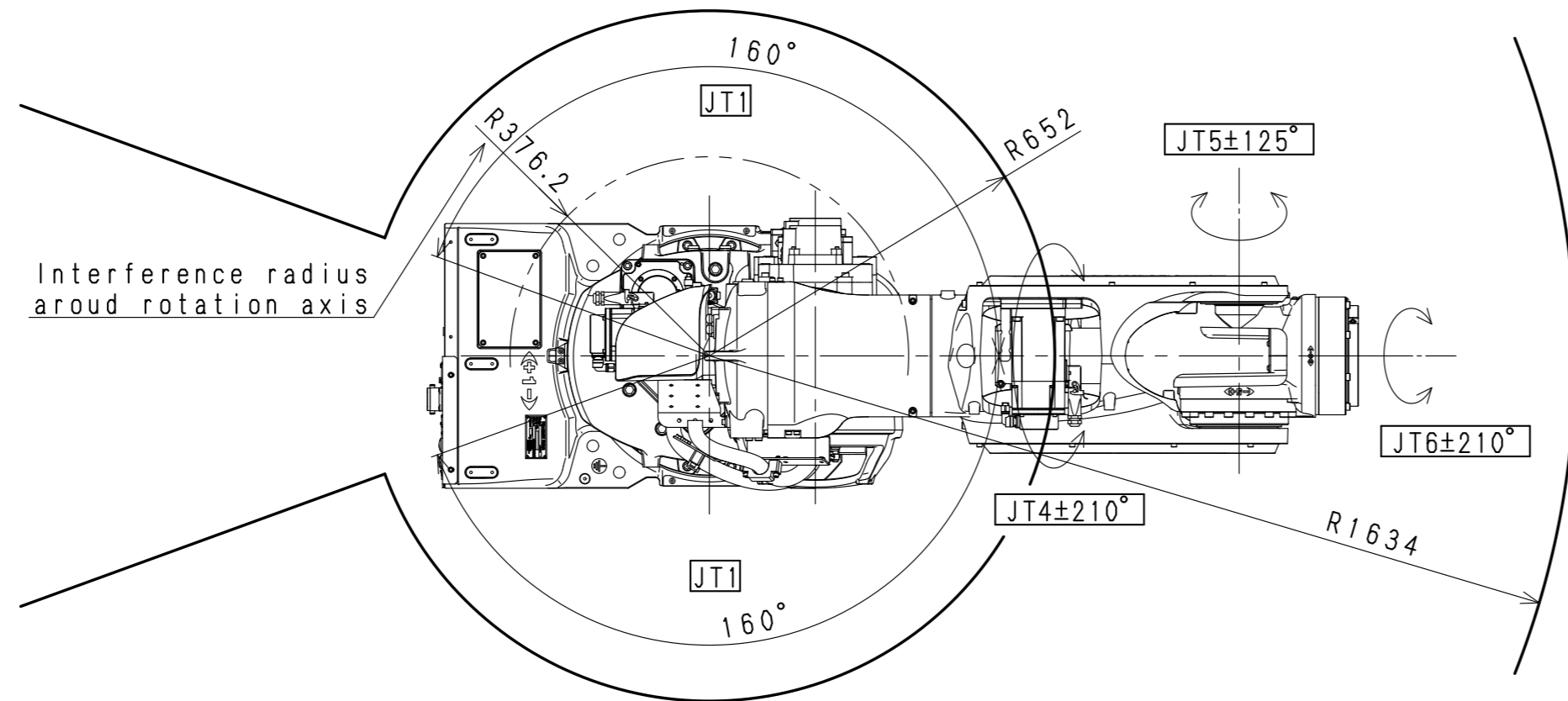

STANDARD FLANGE

※ Dimension:225

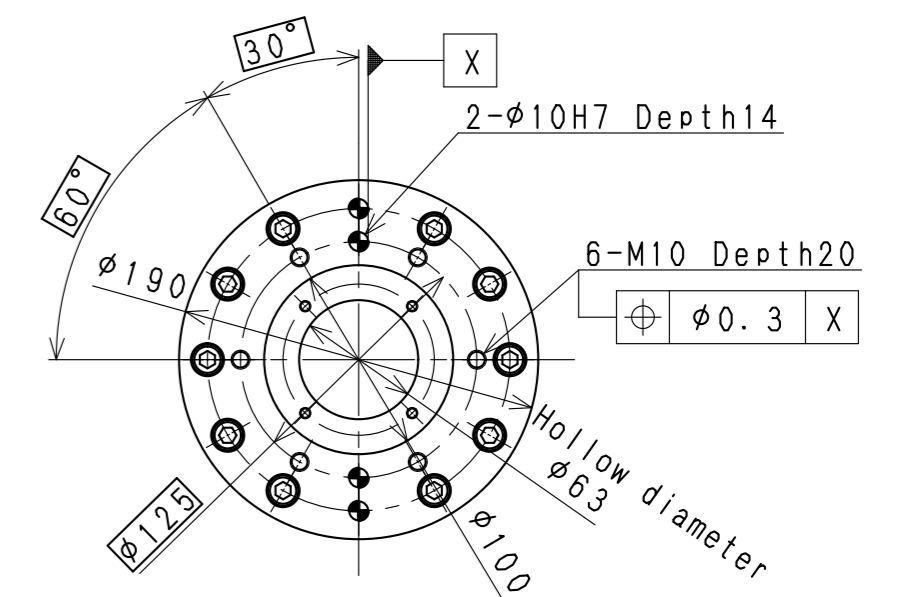

OPTION FLANGE

※ Dimension:245

View A

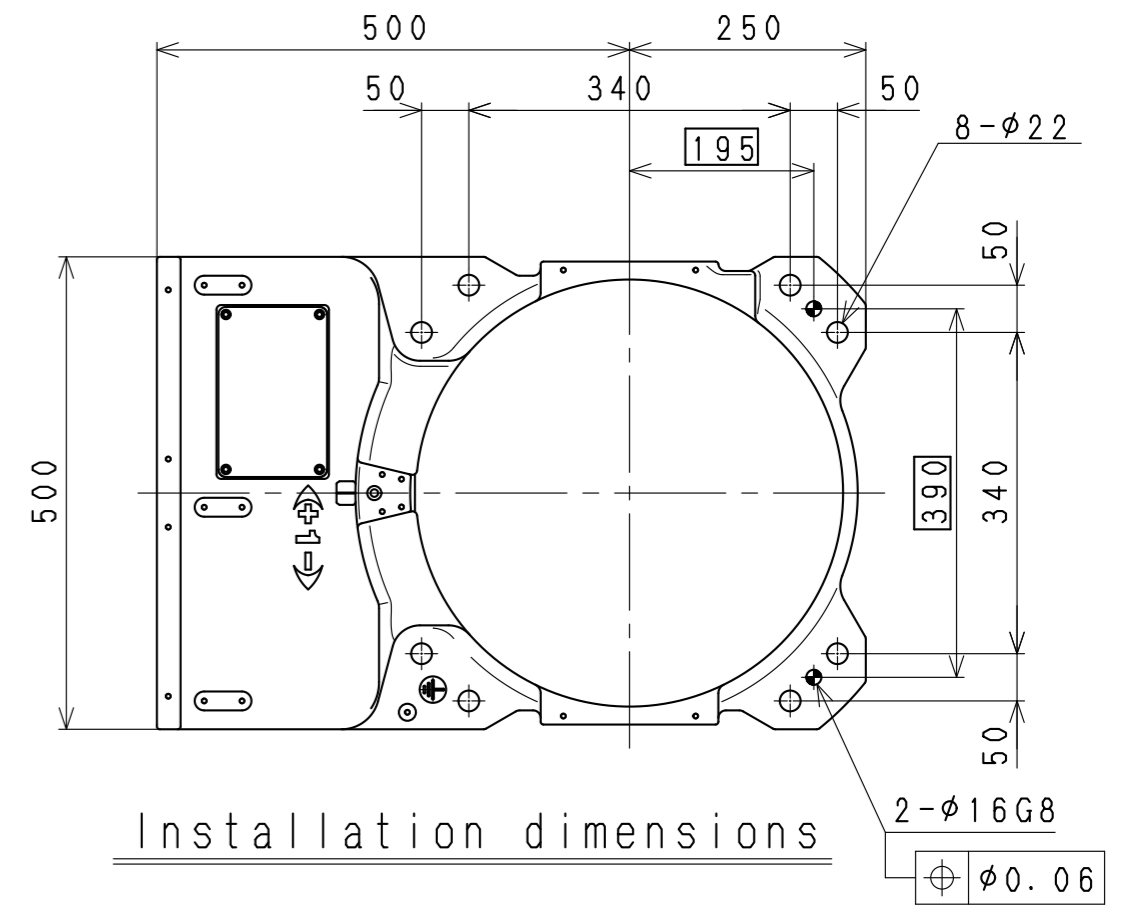
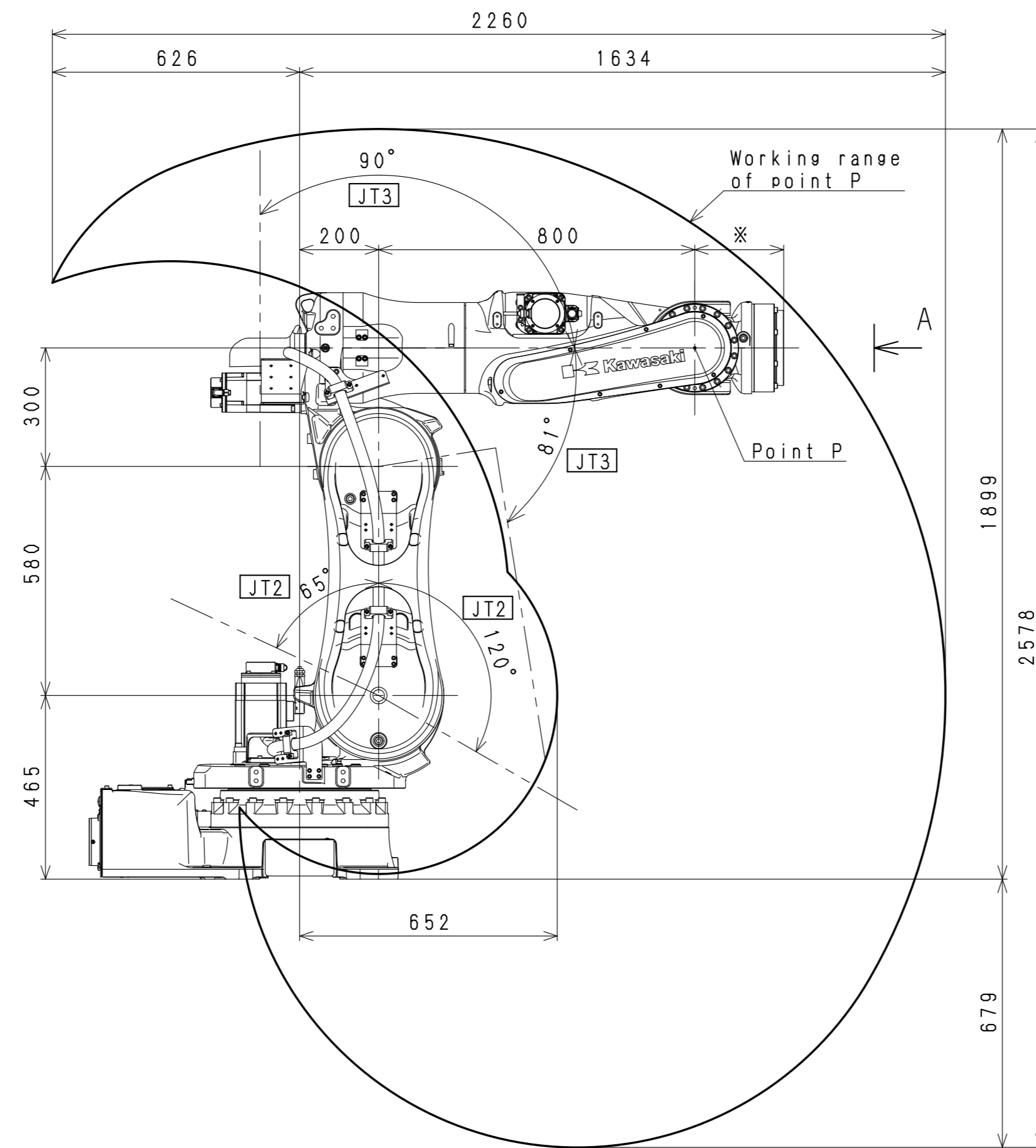

Installation dimensions

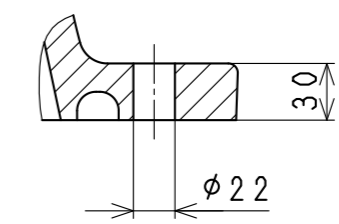

BXP110S
WORKING RANGE

Note.

1. Working range is limited by peripheral device.