



Standard Specifications

MC006V-A

1st ed. 02-Oct-24
2nd ed. 10-Oct-24

Kawasaki Heavy Industries, Ltd.
Robot Business Division

Specification number : 90151-0409DEB

Robotto Specification

1. Model	MC006V-A																														
2. Type	Articulated robot																														
3. Degree of freedom	6 axes																														
4. Max. payload	6 kg																														
5. Max. reach	610 mm																														
6. Position repeatability	±0.03 mm (wrist flange surface) conforms to ISO 9283																														
7. Axis specification	<table><tr><td colspan="2">operating axis</td><td>Motion range</td><td>Max. speed</td></tr><tr><td>Arm rotation</td><td>(JT1)</td><td>±180 °</td><td>400 deg/s</td></tr><tr><td>Arm out-in</td><td>(JT2)</td><td>±130 °</td><td>300 deg/s</td></tr><tr><td>Arm up-down</td><td>(JT3)</td><td>±150 °</td><td>420 deg/s</td></tr><tr><td>Wrist swivel</td><td>(JT4)</td><td>±270 °</td><td>450 deg/s</td></tr><tr><td>Wrist bend</td><td>(JT5)</td><td>±120 °</td><td>450 deg/s</td></tr><tr><td>Wrist twist</td><td>(JT6)</td><td>±270 °</td><td>700 deg/s</td></tr></table>			operating axis		Motion range	Max. speed	Arm rotation	(JT1)	±180 °	400 deg/s	Arm out-in	(JT2)	±130 °	300 deg/s	Arm up-down	(JT3)	±150 °	420 deg/s	Wrist swivel	(JT4)	±270 °	450 deg/s	Wrist bend	(JT5)	±120 °	450 deg/s	Wrist twist	(JT6)	±270 °	700 deg/s
operating axis		Motion range	Max. speed																												
Arm rotation	(JT1)	±180 °	400 deg/s																												
Arm out-in	(JT2)	±130 °	300 deg/s																												
Arm up-down	(JT3)	±150 °	420 deg/s																												
Wrist swivel	(JT4)	±270 °	450 deg/s																												
Wrist bend	(JT5)	±120 °	450 deg/s																												
Wrist twist	(JT6)	±270 °	700 deg/s																												
8. Load capacity of wrist	<table><tr><td></td><td>Max. torque</td><td>Moment of inertia*¹</td></tr><tr><td>JT4</td><td>13 N · m</td><td>0.5 kg · m2</td></tr><tr><td>JT5</td><td>13 N · m</td><td>0.5 kg · m2</td></tr><tr><td>JT6</td><td>7 N · m</td><td>0.2 kg · m2</td></tr></table> <p>Note *¹ Each value in this table shows allowable moment of inertia of JT4/JT5/JT6 when max. allowed torque is applied to each axis. If more detailed data is required for your application, please contact Kawasaki.</p>				Max. torque	Moment of inertia* ¹	JT4	13 N · m	0.5 kg · m2	JT5	13 N · m	0.5 kg · m2	JT6	7 N · m	0.2 kg · m2																
	Max. torque	Moment of inertia* ¹																													
JT4	13 N · m	0.5 kg · m2																													
JT5	13 N · m	0.5 kg · m2																													
JT6	7 N · m	0.2 kg · m2																													
9. Mass	44kg (excluding optional items)																														
10. Mounting	Floor or Ceiling or wall mounting																														
11. Installation Environment	Ambient temperature: 10 - 35 °C																														
	Relative Humidity: 35 - 85 % (with no dew condensation)																														
12. Cleanliness	ISO Class 5 (Fed. Std. 209D Class 100(0.5 μm))																														
13. Degree of protection	IP67 Equivalent (CNB Part IP65)																														
14. External facing* ²	Chrome-plated and buffed (equivalent to # 400)																														
15. Chemical resistance* ³	35% aqueous hydrogen peroxide, 37% formalin, 25% ammonia, 5% sulfuric acid, 30% phosphoric acid																														
	10% acetic acid, 100% isopropanol (evaluated in accordance with ISO4628 -1)																														
16. I/O Type	PNP (Source)																														
17. Encoder battery harness	External extension harness 3m																														
18. Built-in utilities	Standard Set	Sensor Harness	8 circuits																												
		Airport	2 ports (φ6) - 2 outlets(φ6)																												
		Solenoid valve	Double solenoid 2 circuits																												
		Airport (for solenoid valves)	1 port (φ6) - 4 outlets(φ4)																												
19. Options* ⁴																															
I/O Type	NPN (Sink)																														
Encoder battery harness	External extension harness 1~5 m (every 1 m)																														

Note*² : Due to the nature of plating on cast products, gloss fogging or abrasive marks may be visible on the surface, but this does not affect plating performance.

In addition, since the robot arm is a cast product, there is a prosity (size 1.5 mm² or less).

Note*³ : Based on the test results of Fraunhofer Institute. (Report No. KA2311-1476)

Note*⁴ : Not all options can be selected. Please select one type from the corresponding items.

For maintenance parts and spare parts, consult separately.

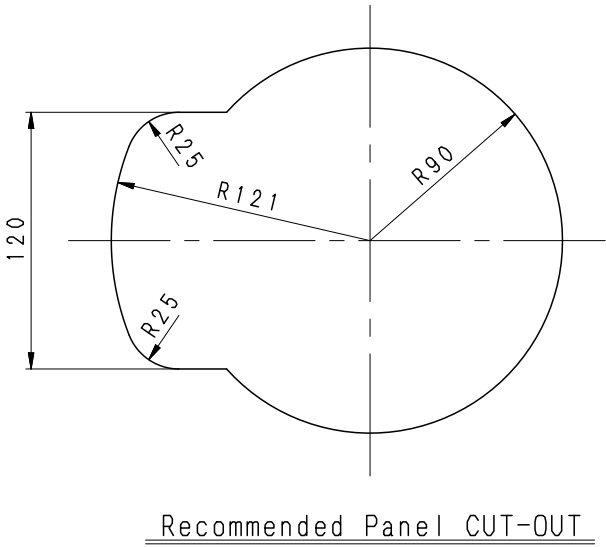
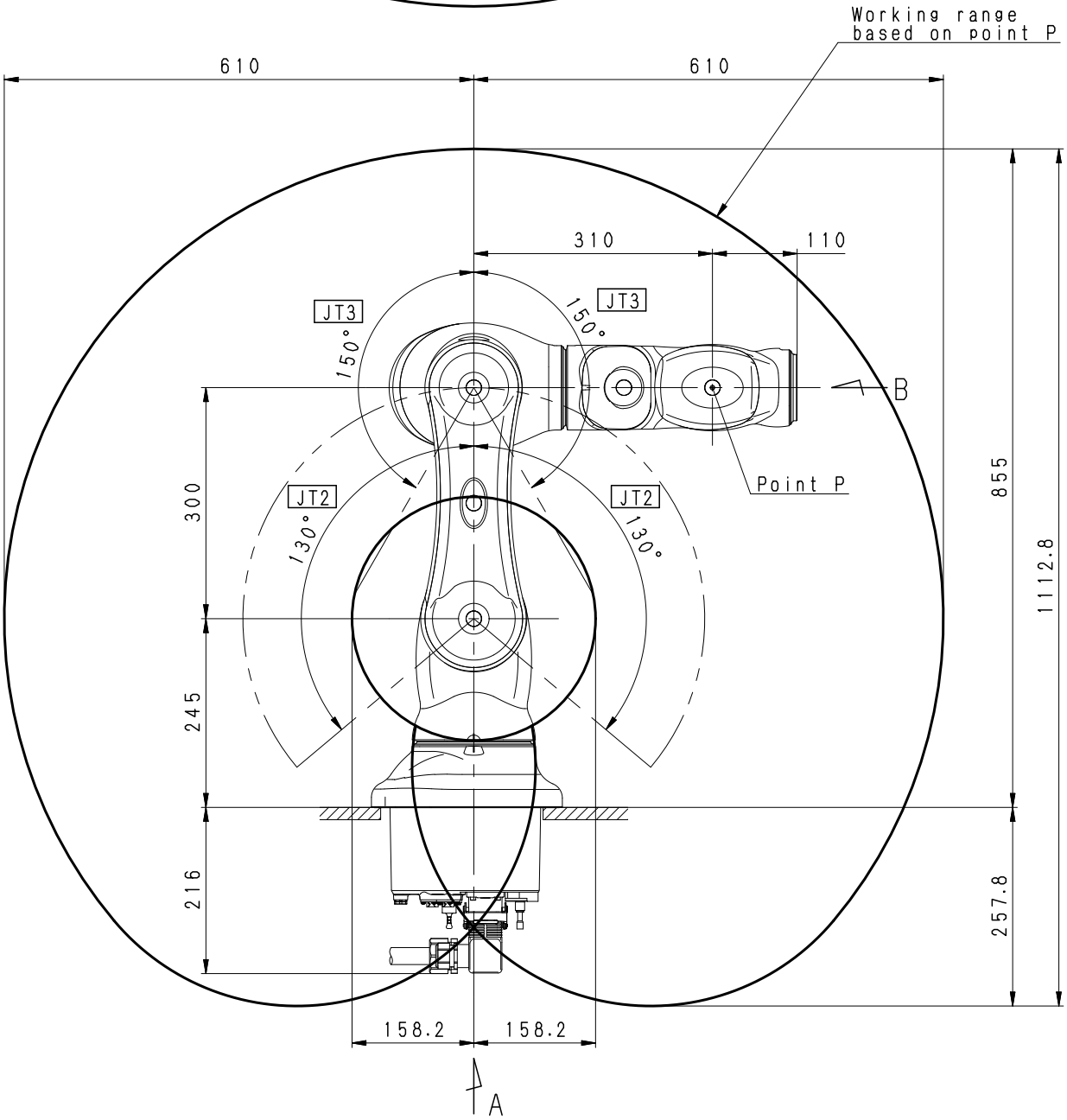
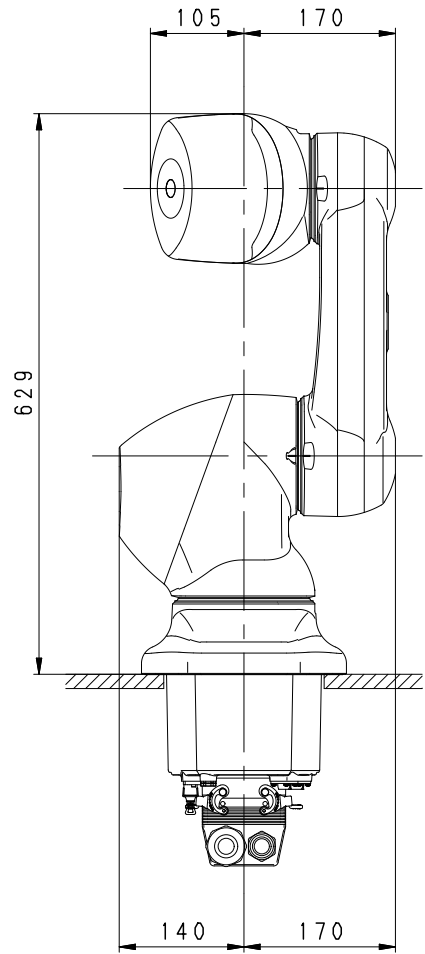
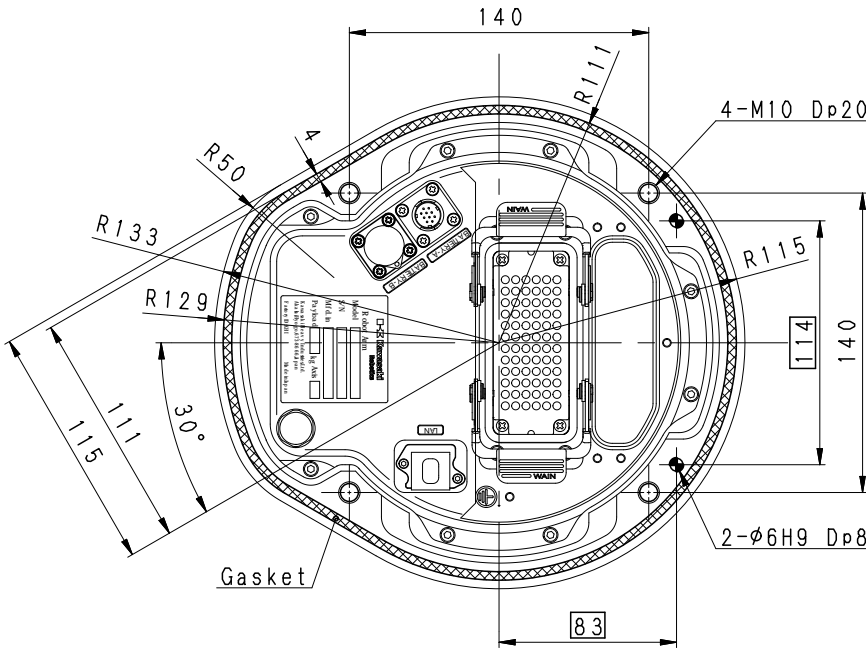
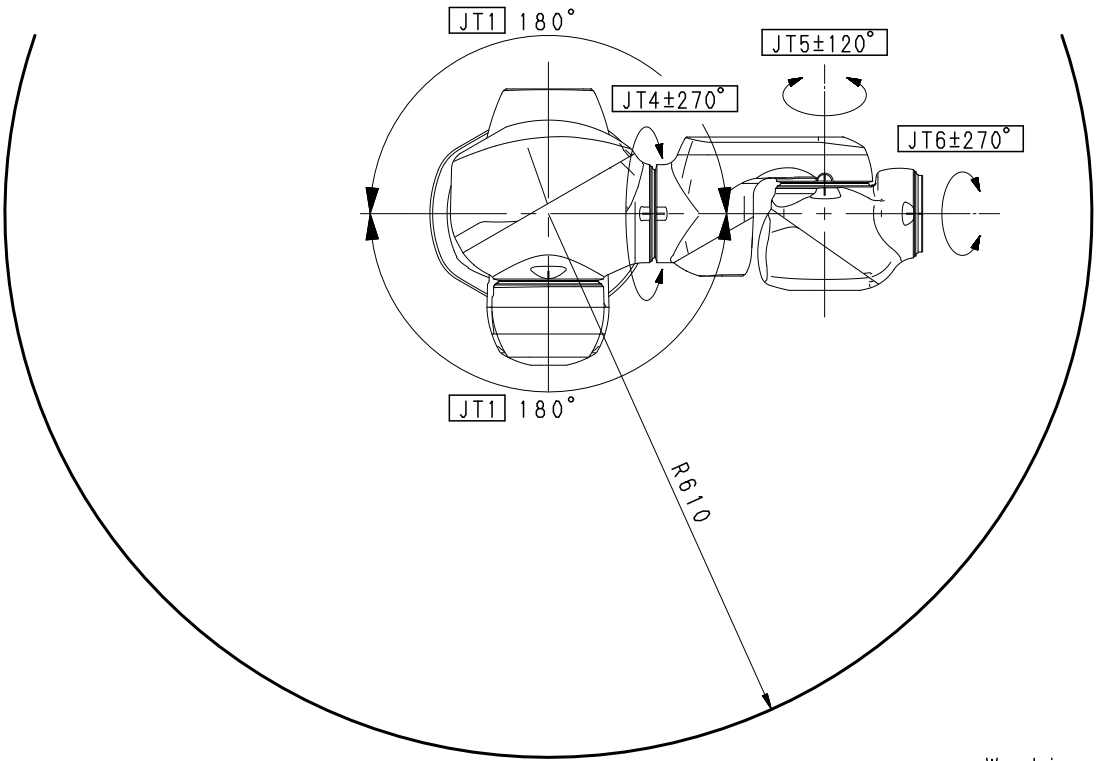
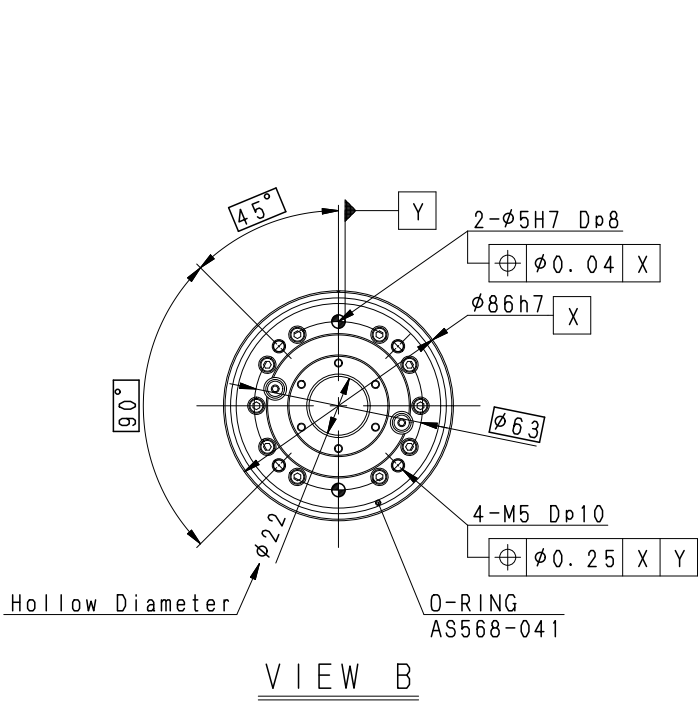

MC006V-A
WORKING RANGE